

South Milwaukee Solo and Ensemble
Saturday, March 28, 2009

South Milwaukee 6-12 Campus
801 15th Avenue
South Milwaukee, WI 53172

Performance Rooms

We are using performance sites rather than room numbers. Please note that Band sites are located on around the MPR in the middle school, String and Piano Sites are in the high school music area and Vocal sites are in the first classrooms of the high school. All sites except site 7 are on the same level. There is an elevator near the homeroom.

All sights except 7 (clavinova) will have acoustic pianos tuned to A=440. Adequate chairs and stands for the largest ensemble in each room will be provided.

The Performing Arts Center (PAC) will house woodwind ensembles and Jazz Ensemble in the morning and vocal ensembles in the afternoon.

There is a classroom (2225) designated for vocal warm-up near the vocal performance rooms. All instrumental warm-ups will be housed in the MS gym, which will also serve as the homeroom for all schools. Security will be on site in the homeroom. PLEASE BE SURE TO CHECK YOUR HOMEROOM AREA BEFORE LEAVING FOR THE DAY SO THAT NOTHING IS LEFT BEHIND.

<u>Site Number</u>	<u>Room number</u>	<u>Events</u>
1	2414 (HS band room)	Stings (including large ensemble)
2	2420 (HS ensemble room)	Strings
3	2402 (HS orchestra room)	Stings (including large ensemble)
4	2409 (HS choir room)	Piano and Female Theater
5	PAC (8-11:50) / 2827 (12:50-3:00)	WW (ensemble) and Jazz Band
6	2829 (8-12) / 2228 (1-2:45)	WW and Female Vocal
7	3900 (MS choir room)	Woodwind
8	2228 (8-12:05) / PAC (1:05-3:30)	Vocal and Large Vocal Ensemble
9	2230	Vocal
10	2908 (MS orchestra room)	Brass
11	2900 (MS band room)	Perc, Brass, and large brass ensemble

Director's Lounge

The MS teachers break room (2826) will serve as a lounge for all directors. Coffee, water and juice will be available throughout the day. All directors can pick up a lunch voucher from the HQ (2352) during the morning to use at the music parent concession stand.

Concessions

Various food items will be for sale throughout the day on an ala Carte basis. The HS commons will serve as a parent and student lounge for the day.

Results

Results will be posted by school in two locations. We will post unofficial results throughout the day on the windows outside the PAC and on the display cases outside the MS Gym (homeroom). Official results and judge's critique sheets will be available from the HQ at the end of the day after the last room has turned in their results.

Judges Copies

MUSIC MUST BE AN ORIGINAL

Please remind your students of the applicable WSMA rules and copyright laws on music. WSMA rules specifically forbid use of copies for adjudicators. By WSMA rules, entries in violation will receive a "critique only" rating.

Equipment furnished

Site 11 will have the following equipment: four timpani, bass drum, orchestra bells, xylophone, marimba, and chime. (You supply anything else, including mallets)

Site 5am/8pm will have a PA system with 4 microphones and stands, extension chords, chairs, stands, drum set and acoustic piano.

Parking and Entrances

Please park in either the northwest faculty lot on the corner of 15th and Oak Creek Parkway or the student parking lot off of Oak Creek Parkway to the east of the HS. Enter the building through doors 9 (main HS entrance), 29 (HS field house), 34 (back between the HS and MS near the HS music wing).

For those with large equipment (basses, tubas, drum sets, amps) please drive up the back access rode around the student lot and unload at door 42 directly to the MS Gym (homeroom). Please park back down in the student lot after unloading.

SOUTH
Milwaukee 15th Avenue campus

Floor 2
 North Campus (High School)

STUDENT/Participant
PARKING

Floor 2
 South Campus (Middle School)

Door 42
 NO LOADING AREA *
 NO PARKING

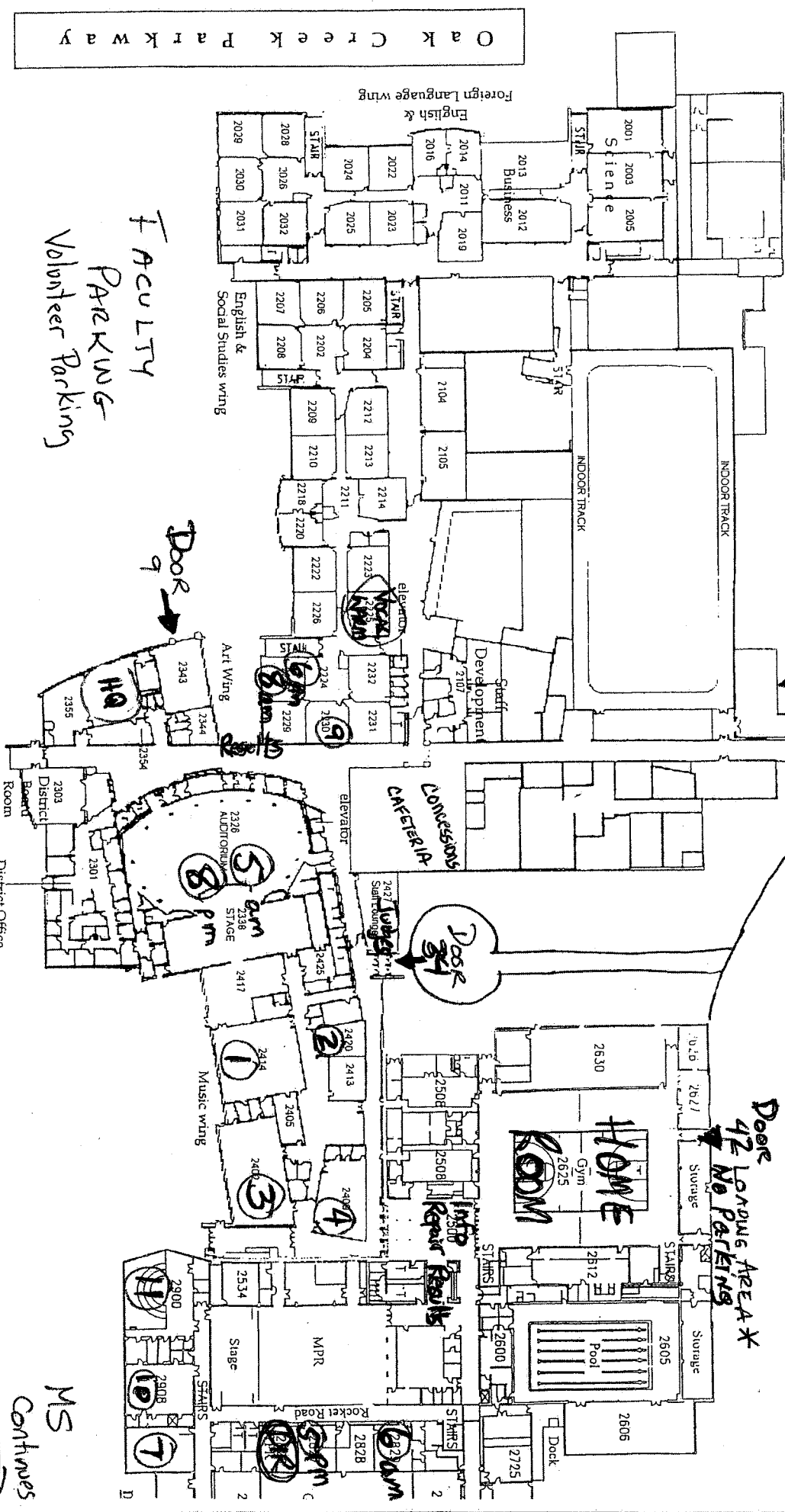

Oak Creek Parkway

15th Avenue

→ N
 to College Ave

Access Road

→ S
 to Rawson Ave

MS
 Continues →